

## LVDT In-Line Signal Conditioner

### Key Features:

- Ultra Compact Only 40mm Long
- Can be used with any AC version LVDT
- Various Outputs: Various Outputs: 4-20mA, 0-5Vdc, 0-10Vdc,  $\pm 2.5$ Vdc
- Enables the Use of a More Compact, Unamplified, LVDT Model
- Supplied Fitted & Calibrated with LVDT



The LVDT in-line signal conditioner is ultra compact and designed to fit 'in-line' on the LVDT cable. It has various output options 4-20mA, 0-5Vdc, 0-10Vdc,  $\pm 2.5$ Vdc.

It is ideal to use if there is not enough space inside the LVDT body and enables you to have a shorter LVDT. This gives you the option of a more compact, unamplified, LVDT model.

If your LVDT is going to be subjected to extreme high or low temperatures, using the in-line signal conditioner enables you to keep the more fragile electronics away from the heat/cold.

The LVDT in-line signal conditioner is fitted and calibrated at our factory prior to shipping to ensure you can use it straight away in your application. [Request pricing](#) from our technical sales team.

### Dimensions:

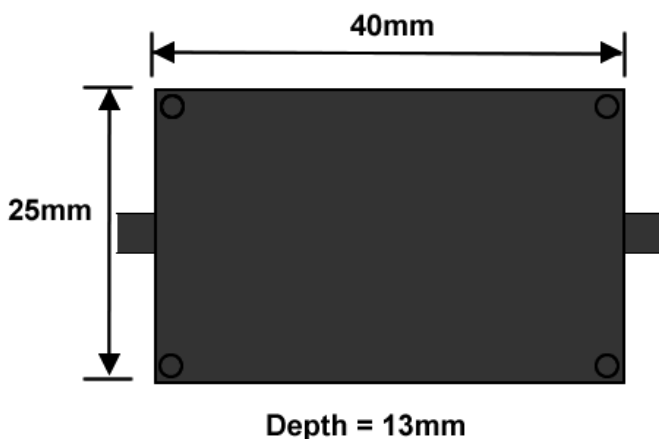

OUTPUT	SUPPLY VOLTAGE
4-20mA	14-24Vdc
0-5Vdc	9-24Vdc
0-10Vdc	14-24Vdc
$\pm 2.5$ Vdc	12Vdc reg

### Associated Products:



[Standard LVDT Displacement Sensor AML/E](#)



[Industrial LVDT Displacement Transducer](#)